



Green
Heaven





Green Heaven is a paradise on earth....

Along with a serene environments
it caters all the wishes as a beautiful host.

A space of your own which will rejuvenate your
mind, body & soul.

A verdant panorama of Comfort, & amenities; a
midst the soothing lifestyles & peaceful
environs. Step into a picturesque world where
your dream will come true.

A residential apartments formed by the
coalition of 100 contemporarily designed
spacious houses for budget home seekers. In
the close proximity to the developing belt of
Atladra-Padra main Road, Vadodara.

Green Heaven is truly a perfect combination of
the contemporary style and futuristic trends
modern forever. They are named by the flowers
as the gifts of nature namely Aster, Tulip, Tares,
Ivy, Iris, Lupin, Larch & Brunia.

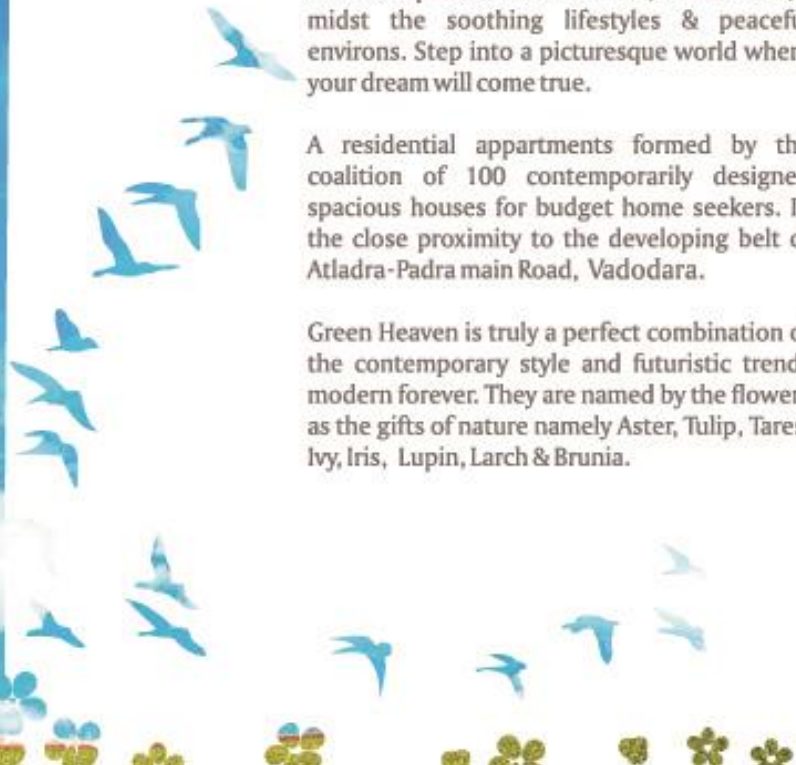



TOWARDS VALDODARA

40 MTRS. WIDE ROAD

TOWARDS PADARA

Party lawn

Senior citizens Sitting

Children Swimming pool

Tennis court

Children play area



SPECIFICATIONS

- Well designed R.C.C. Frame Structure with brick masonry work as per structural and architect design.
- Smooth finished plaster in the Interior walls and ceilings with putty finished and acrylic paints to exterior walls.
- 24" x 24" Vitrified tiles flooring in all rooms & ceramic tiles flooring in all toilets.
- Granite platform with s.s sink and glazed tiles dado upto lintel level above platform.
- 7' height glazed tiles in all toilets.
- Attractive main doors with brass fittings. All other good quality flush door with oil paint.
- Aluminum section window with mosquito grill.
- M.S. safety grills on all windows with oil paint.
- Concealed plumbing with standard fittings.
- Concealed electrification with modular switches. A.C. point in all master bed room, TV point & Telephone point & provision of internet connection.



Owners Plot



Typical Floor Plan



S.B. AREA
1400 sq.ft.



Brunia

Aster

The most striking feature about this setup is its thematic nomenclature & vibrant color scheme.

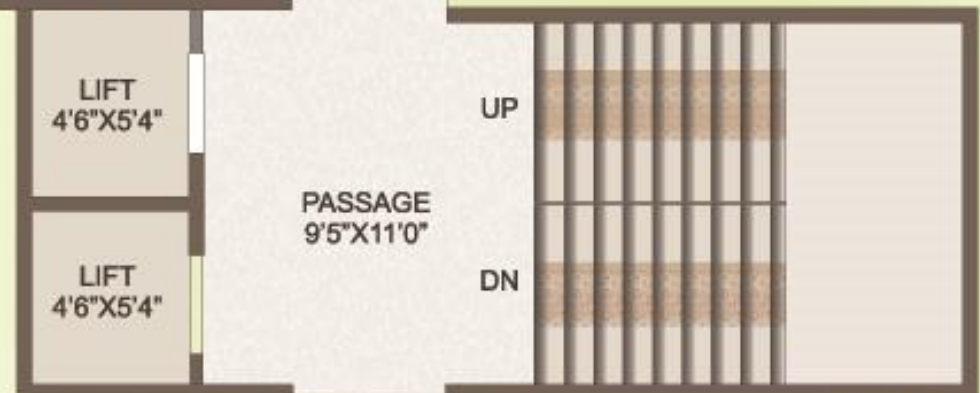



Meticulously worked out floor plan & spacious well designed rooms assures absolute comfort on a tranquil & eco-friendly set up.



WIDE
PASSAGE

UP

DN

6

S. B. AREA
975 sq.ft



KITCHEN
8'1"x9'0"

WASH
4' WIDE

LIVING ROOM
12'4"x15'4"

BED ROOM
10'0"x12'0"

BED ROOM
10'0"x11'0"

TOILET
4'0"x5'10"

TOILET
4'0"x5'10"





S.B. AREA
1375 sq.ft. TO 1500 sq.ft.





AMENITIES

- Well elevated Main Entrance gate with security cabin.
- 24 hours security with intercom facility.
- Periphery compound wall for gated community.
- Landscaped garden for common plot.
- Concrete roads & pavers for dust free environment.
- Underground cabling for power supply.
- Yoga deck.
- Children Park.
- Jogging track.
- Party/Event lawn.
- Senior citizen sitting.
- Skating rink, Basket Ball & Tennis court.
- Generator facility for common passage & Lift.
- 24 Hour water supply with auto control mechanism.

CLUB HOUSE

- | | |
|------------------------|---------------------------------|
| • Air-conditioned Gym. | • Children Swimming Pool |
| • Luxury lounge. | • General Store in Green Heaven |
| • Indoor game room. | |
| • Multi purpose hall. | |



Developers: Heaven Associate

Atladra-Padra main Road, Nr. Bhayali Station,
Nr. Banco Products Ltd., Vadodara.
M: +91 77780 77464, +91 96246 88550

W greenheaven2011.com
E greenheaven2011@yahoo.com

Architect: Ruchir Sheth
Structure Design: Shreeji Structural



We Request : • Document charges, maintenance deposit & all government taxes (if applicable) are extra. • Possession of said flats shall be given after 30 days of full payments & maintenance deposit. • The developers reserve their rights to make any additions, alterations in elevation, plan & F.S.I. Association shall be formed between all the members of the flats & member shall be bound by rules and regulations of the association. • Any specification or information in this brochure cannot form part of an offer, contract or agreement.